

## STILES AND RAILS WITH FINGER JOINTED OAK SIDE STRIPS

**Technical information:**

**Wood:** European Oak (*Quercus robur*)

**Quality:** A/A

**Moisture:**  $9 \pm 2\%$

**Construction:** Top and bottom layer - 2 mm thickness lamella; side strips - finger jointed oak strips; middle layer - finger-jointed A/B quality oak support

**Gluing:** cold gluing D3 class glue

**Finishing:** unfinished

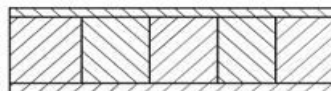

Stiles and rails for the doors

### Standard measurement door stiles and rails

Product	Height, mm	Width, mm	Length, mm	Quality
ECO Stile 100 B	43	100	2100	A/A
ECO Stile 120 B	43	120	2100	A/A
ECO Rail 100 B	43	100	700	A/A
ECO Rail 120 B	43	120	700	A/A
ECO Rail 140 B	43	140	700	A/A
ECO Rail 165 B	43	165	700	A/A

Note: Other measurements are available too.

For more information please contact us: [ecowood@ecowood.eu](mailto:ecowood@ecowood.eu)